







Jayco SEISMIC LUXURY SERIES

-  STORAGE
-  MICRO MICROWAVE
-  OHC OVERHEAD CABINETS
-  FRIDGE REFRIGERATOR
-  WARD WARDROBE

3512 OPTIONS: A, B



OPTIONS

- A**
- 
- Queen Bed
- B**
- 
- Residential Refrigerator

3815 OPTIONS: A, B



4113 OPTIONS: A, B

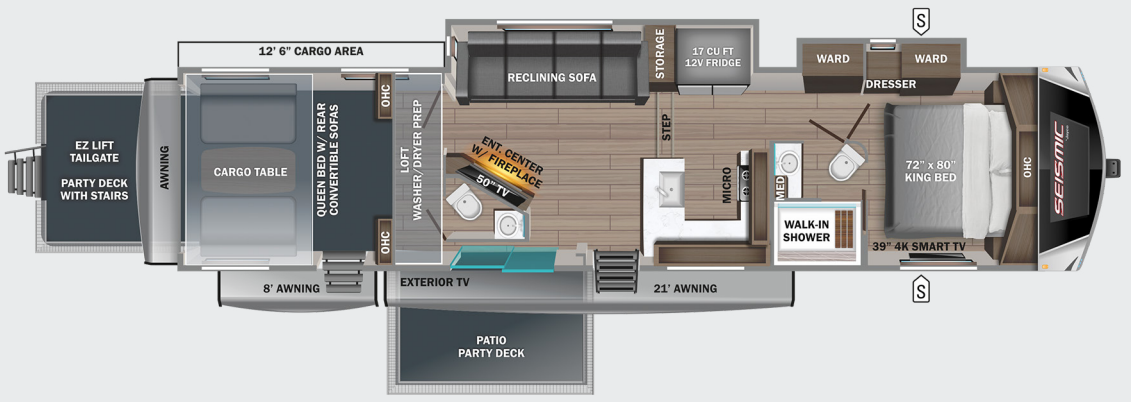

SEISMIC LS PAINT OPTIONS



Metallic Ice



Velocity Blue



Victory Red

STANDARDS & OPTIONS

EXTERIOR

102 in. wide-body structural steel I-beam construction
 3-season removable garage wall
 Battery disconnect
 Climate Shield™ zero-degree tested weather protection:
 40,000 BTU output furnace
 Double layer fiberglass batt insulation (roof and floor)
 Fully enclosed and heated underbelly (ducted)
 PEX plumbing
 Custom automotive-grade vinyl exterior graphics package
 Detachable shore power cord
 Digital TV antenna with Wi-Fi extender
 Dual 30 lb. propane bottle with auto regulator
 Exterior marine-grade speakers with Bluetooth® controller
 Folding roof ladder
 Fully enclosed, LED-lit universal docking center:
 Black tank flush
 Independent satellite wiring
 Quick-connect outside shower
 Whole coach cable hookups
 Winterization and sanitation
 Helix Cooling System™ (industry exclusive):
 Directional and closeable A/C vents
 Jayco exclusive insulated dual duct design
 Larger return air vents with user-accessible filters
 Two exterior-mounted 15,000 BTU "Whisper Quiet" A/C unit (living room and bedroom)
 JayPort for outside griddle
 JaySMART™ (Safety Markers And Reverse Travel) LED lighting (patented)
 LED exterior lighting package
 Magnum Truss™ Roof System (strongest tested roof in the industry) with one piece, seamless roof material with 20 year warranty
 MORryde Safe-T-Rail grab handle
 Oversized multi-battery compartment (industry leading room for 4-6 batteries)
 Painted fiberglass front cap with clear coat and built-in specialty LED lighting
 Pass-through storage with Slam-latch™ baggage doors
 Stronghold VBL™ aluminum framed and vacuum bond laminated gelcoated fiberglass exterior walls (including slide room end walls)
 Under-mounted spare tire
 Water heater bypass

INTERIOR

"Shoe garage" in hallway step (select models)
 12V charging station
 17 cu. ft. 12V refrigerator
 5/8 in. tongue-and-groove joined plywood floor decking and 3/8 in. tongue-and-groove joined plywood roof decking
 Bathroom skylight
 C.P.A.P. prepped bedroom
 Carbon monoxide and propane detector
 Custom interior design - Vintage Farmhouse
 Dual USB charging ports (kitchen and bedroom)
 Gas-strutted under-bed storage
 Hallway window
 Handcrafted hardwood glazed doors, drawers and trim
 Hardwood safety handrail on steps
 Heavy-duty, 75 lb., full-extension, steel ball-bearing drawer guides
 Inverter pre-wire
 JAYCOMMAND® "Smart RV" system

JayVoice voice command system - controls lighting, A/C and furnace
 Kitchen faucet with pull-out sprayer
 LED backlit custom framed mirror and medicine cabinet
 LED fireplace with electric space heater (select models)
 LED interior lighting throughout
 Porcelain foot flush toilet
 Pull-out spice rack above microwave (select models)
 Residential quilted bedspread and pillow shams
 Residential vinyl flooring (made in the USA)
 Solid hardwood slide fascia and cabinet doors
 Stainless steel kitchen sink
 SuperSofa with heat, massage, recliners and LED lighting
 Vinyl flooring in slideouts (no carpet)

RAMP AND CARGO EQUIPMENT

2 in. block-foam fully insulated garage floor (industry first)
 Dual 30 gal. fuel tanks with timer (1 dedicated to generator)
 Garage D-rings mounted to steel frame
 HappiJac® electric-lift queen beds/convertible sofas with folding armrests and cup holders
 LED high-intensity ramp lights
 Ram air vents and power roof vent
 Ramp patio kit with exterior steps
 Rear electric patio awning
 Rear ramp door and patio with anti-slip, non-skid flooring
 Three seasons garage wall/doors (removable)
 Tuff-ply, rubberized garage floor liner

CUSTOMER VALUE PACKAGE (MANDATORY)

16 gal. gas/electric DSI water heater
 39 in. 4K Smart bedroom TV
 4K Smart LED HDTV with fully digital HDMI® output
 50-amp service and 3rd A/C prep
 NPS - Powered by Yamaha 6,000 watt generator, gas/C.A.R.B. certified
 Automotive style front windshield
 Backup, main entrance door and side observation security camera prep (includes a power switch in the bedroom to use the optional 7 in. monitor for security)
 Bathroom power vent
 Cellular prep for 4G WiFi repeater and JAYCOMMAND® "Smart RV" system
 Custom machined aluminum rims
 Dual electric awnings with LED lights
 Frameless dark tinted safety-glass windows
 Fresh Water Drinking System (patented)
 GE Profile Series 30 in. residential convection microwave with built in air fryer
 GE Profile Series residential 24 in. range (3.7 cu. ft. with 9,100 BTU high output burner)
 Hidden hinges on cabinet doors
 High gloss gelcoated exterior sidewalls
 Hydraulic 6-point auto-leveling system with oversized foot pads
 JAYCOMMAND® "Smart RV" system powered by BMPRO®
 JBL® home entertainment system with sound bar and subwoofer
 Keyed-Alike™ lock system
 MORryde® StepAbove™ entrance steps with strut assist (main entrance)
 Night roller shades in living room
 Residential "walk-in" shower with shampoo/soap holder, teak seat and shower tower
 Residential king (72 in. x 80 in.) mattress with under-bed storage

Residential solid-surface kitchen countertop with bamboo sink cover and strainer
 Rooftop and ground solar prep
 Washer/dryer prep
 Wireless remote control system (includes Bluetooth® wireless interior controls) with dimmer switches

5-STAR HANDLING PACKAGE (MANDATORY)

17.5 in. 16 ply 'H' rated Uniroyal tires
 Dexter® Axles with ABS and Tow Assist - includes Nev-R-Adjust® brakes and E-Z Lube® hubs
 MORryde® CRE-3000™ rubberized suspension
 MORryde® pin box
 Wet bolt fasteners, bronze bushings and 4,000 lb. leaf springs

OPTIONS

15,000 BTU drop-in cargo area A/C
 32 in. 4K Smart LED cargo TV
 7K hydraulic disc brake package (ABS N/A with disc brakes)
 8K hydraulic disc brake package (ABS N/A with disc brakes)
 Customer Value Package with 15,000 BTU A/C and heat pump
 Extreme Weather Package:
 120V heated holding tank pads
 12V wrapped and heated fresh water line
 Interior illuminated switch
 Frameless dual-pane tinted safety-glass windows
 Full body paint options: Metallic Ice, Velocity Blue and Victory Red
 GE 21 cu. ft. residential refrigerator with 1800W inverter
 MORryde independent suspension with 8K axles and disc brakes (ABS not available)
 Overlander 2 Solar Package: 30-amp solar controller and (2) roof-mounted 200W solar panels with 1800W inverter
 Overlander 4 Solar Package: (4) 200W solar panels, (2) 100-amp/hour lithium heated batteries, 60-amp controller, 3000W inverter, DC/DC power converter, soft start power save main 15K A/C, soft start power save for bedroom 15K A/C, battery monitor, energy management system, roof pre-wire for additional solar panels, generator option compatible and heavy gauge steel battery enclosure
 Overlander EXT Solar Package: 3000W inverter/charger with internal 50-amp transfer switch, energy management system, (6) solar panels with 200W each, (6) 100-amp/hour lithium heated batteries, 12V DC A/C in bedroom, DC to DC battery charger, 100-amp MPPT controller management, generator prep capable
 Patented Outside Tailgater Camp Kitchen
 Queen residential foam-top mattress
 Sani-Con® Turbo Waste Management System
 Slideout awnings (quantity varies by model) (standard 4113)
 Truma on-demand water heater
 Wireless backup/rear, side view and front entrance door observation camera kit (includes a power switch in the bedroom to use the optional 7 in. monitor for security)

The 5-Star Handling Package is a Jayco exclusive, a powerful blend of high-end American-made components that make pulling a luxury fifth wheel a breeze.



DEXTER® AXLES WITH ABS & TOW ASSIST - INCLUDES NEV-R-ADJUST® BRAKES & E-Z LUBE® HUBS

The Benchmark of the trailer industry!

MORryde® PIN BOX

Allows pin box to travel forward and backward as well as side-to-side, creating a smoother tow.

DEXTER® HEAVY-DUTY 1/2" SHACKLES WITH WET BOLT FASTENERS AND BRONZE BUSHINGS

Resists the wear-and-tear of towing.

MORryde® RUBBERIZED SUSPENSION SYSTEM

Better absorbs and isolates road shock.

UNIROYAL® TIRES

17.5 in. 'H' Rated

*Indicates split tanks

| FLOORPLAN | EXTERIOR TRAVEL LENGTH | EXTERIOR WIDTH | EXTERIOR HEIGHT (WITH A/C) | INTERIOR HEIGHT (MAIN) | INTERIOR HEIGHT (UPPER DECK) | UNLOADED VEHICLE WEIGHT | DRY HITCH WEIGHT | GVWR | CARGO CARRYING CAPACITY | FRESH WATER CAPACITY (INCLUDING WATER HEATER) | GRAY WASTE WATER CAPACITY | BLACK WASTE WATER CAPACITY | SLEEPING CAPACITY |
|-----------|------------------------|----------------|----------------------------|------------------------|------------------------------|-------------------------|------------------|--------|-------------------------|---|---------------------------|----------------------------|-------------------|
| 3512 | 41' 8" | 8' 6" | 13' 3" | 8' 3" | 6' 4" | 14,300 | 3,155 | 17,650 | 3,350 | 106 | 87* | 87* | 5-7 |
| 3815 | 44' 10" | 8' 6" | 13' 3" | 8' 3" | 6' 4" | 14,875 | 3,610 | 19,995 | 5,120 | 106 | 87* | 87* | 5-7 |
| 4113 | 45' 8" | 8' 6" | 13' 3" | 8' 3" | 6' 4" | 15,815 | 3,550 | 20,695 | 4,880 | 106 | 87* | 87* | 5-7 |

Meet your Jayco Dealer



Scan QR code for specification definitions

Some specs at the time of print may include estimates. For the most updated information, please visit Jayco.com

Jayco, Inc. | P.O. Box 460 | Middlebury, IN 46540

See dealer for further information and prices. All information in this brochure and on www.jayco.com is the latest available at the time of publication approval. Jayco reserves the right to make changes and to discontinue models without notice or obligation. Photography may show optional equipment or props used for decoration purposes only. RVs built for sale in Canada may differ to conform to Canadian codes. JAYCO and the JAYCO BIRD IN FLIGHT are registered trademarks of Jayco, Inc. Printed in USA 10/23 ©2023 Jayco, Inc.



Jayco - Part of Jayco Family of Companies