

359

OPTION: A

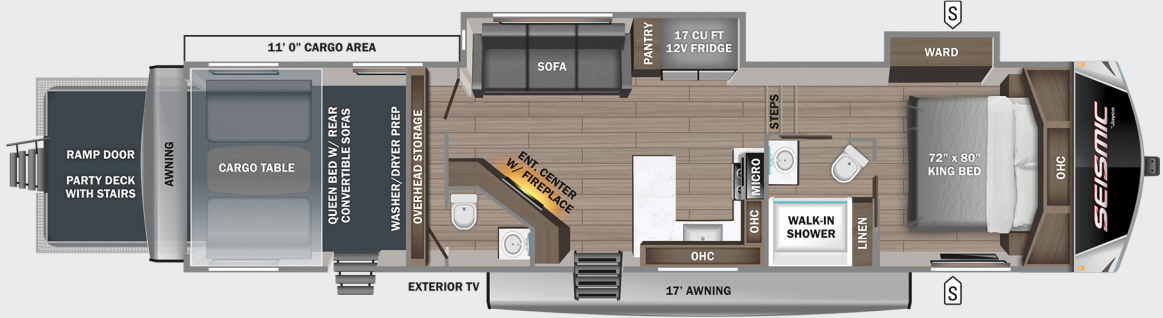

OPTIONS

A



Queen Bed

B



Half Bath

C



Super Sofa

395

OPTIONS: A, B, C

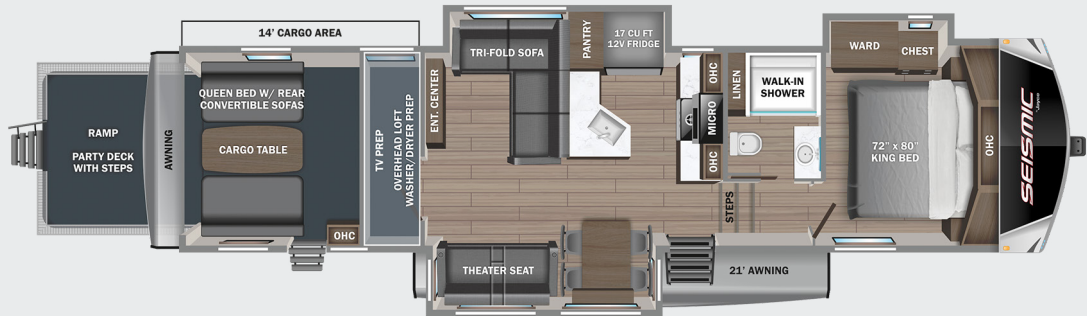

403

OPTION: A



405

OPTION: A



STORAGE

MICRO

MICROWAVE

OHC

OVERHEAD CABINETS

FRIDGE

REFRIGERATOR

WARD

WARDROBE

# STANDARDS & OPTIONS

## EXTERIOR

102 in. wide body structural steel I-beam construction  
 Next-Gen Power Systems - Powered by Yamaha 6,000 watt generator, gas/C.A.R.B. certified  
 6-point hydraulic auto-leveling system  
 Battery disconnect switch  
 Climate Shield™ zero-degree tested weather protection:  
 - PEX plumbing  
 - 35,000 BTU output furnace  
 - Double layer fiberglass batt insulation in ceiling and floor  
 - Double sided radiant barrier insulation (roof and floor)  
 - Fully enclosed and heated underbelly (ducted)  
 Custom automotive-grade vinyl exterior graphics package  
 Detachable shore power cord  
 Digital TV antenna  
 Dual 30 lb. propane bottles with auto regulator  
 Exterior marine-grade speakers  
 Folding roof ladder  
 Fully enclosed, LED-lighted universal docking center:  
 - Black tank flush, winterization and sanitation  
 - Quick-connect outside shower  
 - Satellite prep  
 HELIX Cooling System™ (industry exclusive):  
 - Directional and closeable A/C vents  
 - Jayco-exclusive insulated dual duct design  
 - Two exterior-mounted 15,000 BTU ducted A/Cs (living room and bedroom)  
 JaySMART™ (Safety Markers And Reverse Travel) LED lighting (patented)  
 LED exterior lighting package  
 Propane quick-connect  
 Magnum Truss™ Roof System (strongest tested roof in the industry) with one piece, seamless roof material with 20 year warranty  
 Painted fiberglass front cap with clear coat and built-in specialty LED lighting  
 Pass-through storage with Slam-latch™ baggage doors  
 Stronghold VBL™ aluminum framed and vacuum bond laminated gelcoated fiberglass exterior walls and slide room end walls  
 Under-mounted spare tire  
 Water heater bypass

## INTERIOR

12V charging station  
 5/8 in. tongue-and-groove joined plywood main floor decking and 3/8 in. tongue-and-groove plywood in the roof  
 Bathroom skylight  
 Carbon monoxide and propane detector  
 Central command center with built-in tank monitoring  
 Custom interior design - Vintage Farmhouse

Gas-strutted under-bed storage  
 Handcrafted and glazed doors, drawers and trim  
 Hardwood safety handrail on steps  
 Heavy-duty, 75 lb., full-extension, steel ball-bearing drawer guides  
 Inverter pre-wire  
 Kitchen faucet with pull-out sprayer  
 LED fireplace with electric space heater (select models)  
 LED interior lighting throughout  
 Porcelain foot flush toilet  
 Residential quilted bedspread  
 Residential vinyl flooring (made in the USA)  
 Solid hardwood cabinet doors  
 Stainless steel kitchen sink  
 SuperSofa with heat, massage and LED lighting  
 Two removable cup holder sofa tables  
 Vinyl flooring in slideouts (no carpet)  
 Washer/dryer prep

## RAMP AND CARGO EQUIPMENT

30 gal. fuel tank with timer  
 Garage D-rings mounted to steel frame  
 HappiJac® electric-lift queen beds/convertible sofas with folding armrests and cup holders  
 LED high-intensity ramp lights  
 Ram air vents and power roof vent  
 Ramp patio kit with exterior steps  
 Rear electric patio awning  
 Rear ramp door and patio with anti-slip, non-skid flooring  
 Three seasons removable garage wall/doors  
 Tuff-ply, rubberized garage floor liner

## CUSTOMER VALUE PACKAGE (MANDATORY)

16 gal. gas/electric DSI water heater  
 17 cu. ft. 12V refrigerator  
 4K Smart LED HDTV with fully digital HDMI® output  
 50-amp service and 3rd A/C prep  
 AM/FM/CD/DVD/Bluetooth® stereo with 4 speakers  
 Bathroom power vent  
 Custom machined aluminum rims  
 Electric awning with LED lights  
 Hidden hinges on cabinet doors  
 Keyed-Alike™ lock system  
 Microwave  
 MORryde® strut-assisted fold-away entrance steps (main entrance)  
 Night shades  
 Oven with 3-burner recessed cooktop with glass cover  
 Residential king (72 in. x 80 in.) mattress with under bed storage  
 Rooftop and ground solar prep

## 4-STAR HANDLING PACKAGE (MANDATORY)

17.5 in. 16 ply 'H' rated Uniroyal tires  
 Dexter® Axles with ABS and Tow Assist - includes Nev-R-Adjust® brakes and E-Z Lube® hubs  
 ROTA-FLEX™ pin box  
 Wet bolt fasteners, bronze bushings and 4,000 lb. leaf springs

## OPTIONS

Frameless dual-pane tinted safety-glass windows  
 Outside griddle for JayPort system  
 Overlander 2 Solar Package: 30-amp solar controller with (2) roof-mounted 200W solar panels and a 1800W inverter  
 Overlander 4 Solar Package: (4) 200W solar panels, (2) 100-amp/hour lithium heated batteries, 60-amp controller, 3000W inverter, DC/DC power converter, soft start power save main 15K A/C, soft start power save for bedroom 15K A/C, battery monitor, energy management system, roof pre-wire for additional solar panels, generator prep capable and heavy gauge steel battery enclosure  
 Queen residential foam-top mattress

\*Indicates split tanks

FLOORPLAN	TOTAL EXTERIOR LENGTH	EXTERIOR WIDTH	EXTERIOR HEIGHT (WITH A/C)	INTERIOR HEIGHT (MAIN)	INTERIOR HEIGHT (UPPER DECK)	UNLOADED VEHICLE WEIGHT	DRY HITCH WEIGHT	GVWR	CARGO CARRYING CAPACITY	FRESH WATER CAPACITY (INCLUDING WATER HEATER)	GRAY WASTE WATER CAPACITY	BLACK WASTE WATER CAPACITY	SLEEPING CAPACITY
359	41' 9"	8' 6"	13' 2"	8' 2"	6' 4"	13,220	2,910	16,995	3,775	106	87*	87*	5-7
395	45' 7"	8' 6"	13' 4"	8' 3"	6' 4"	14,890	3,310	19,995	5,105	106	87*	87*	5-7
403	41' 6"	8' 6"	13' 3"	8' 3"	6' 4"	13,375	3,030	16,500	3,125	106	87*	87*	5-7
405	41' 6"	8' 6"	13' 3"	8' 3"	6' 4"	13,800	2,895	16,995	3,195	106	87*	87*	5-7

Meet your Jayco Dealer



Scan QR code for specification definitions

Some specs at the time of print may include estimates. For the most updated information, please visit [Jayco.com](http://Jayco.com)

Jayco, Inc. | P.O. Box 460 | Middlebury, IN 46540

See dealer for further information and prices. All information in this brochure and on [www.jayco.com](http://www.jayco.com) is the latest available at the time of publication approval. Jayco reserves the right to make changes and to discontinue models without notice or obligation. Photography may show optional equipment or props used for decoration purposes only. RVs built for sale in Canada may differ to conform to Canadian codes. JAYCO and the JAYCO BIRD IN FLIGHT are registered trademarks of Jayco, Inc. Printed in USA 10/23 ©2023 Jayco, Inc.



Jayco - Part of Jayco Family of Companies