



EAGLE HT FW

- S** STORAGE
- MICRO** MICROWAVE
- OHC** OVERHEAD CABINETS
- FRIDGE** REFRIGERATOR
- WARD** WARDROBE

OPTIONS

- A**

Dinette
- B**

Griddle/Sink
- C**

Tri-fold Sofa

25RUC OPTION: B

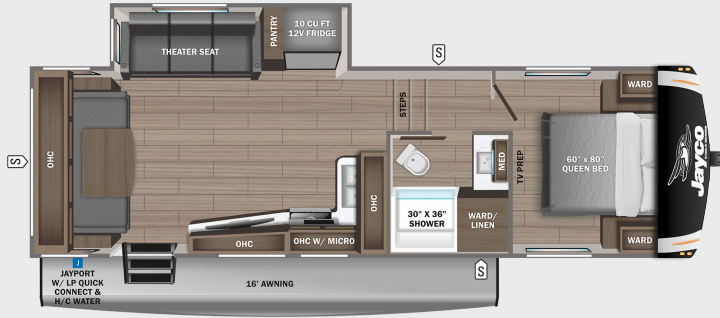

26REC OPTIONS: A, B, C

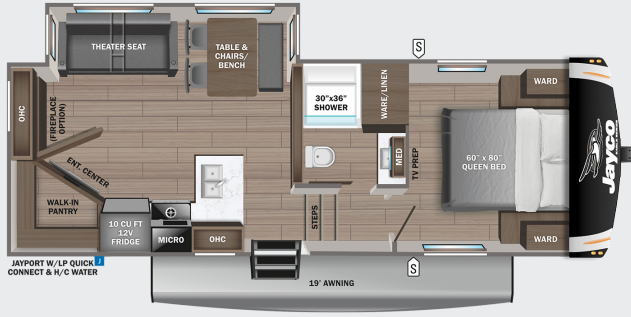

29DDB OPTION: C

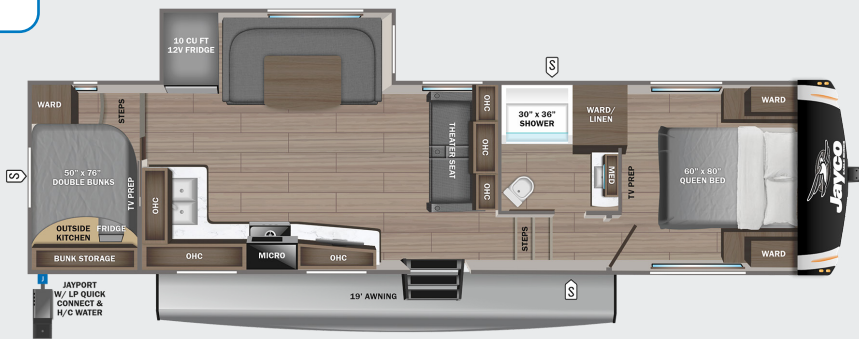

29RLC OPTIONS: A, B, C



STANDARDS & OPTIONS

EXTERIOR

1.5 in fresh water drain valve
 5 in. Magnum Truss™ Roof System with limited lifetime warranty
 50-amp detachable power cord
 Auto-grade vinyl graphics
 Automotive style painted front cap with max turn radius
 Black tank flush
 Climate Shield™ zero-degree tested weather protection:
 - Fully enclosed and heated underbelly (ducted)
 - 35,000 BTU furnace
 - Double layer fiberglass batt insulation in ceiling and floor
 - Double sided radiant barrier insulation (roof, floor and behind cap)
 - PEX plumbing
 Commercial grade rubber flooring in pass through area
 Digital TV antenna with WiFi prep
 Dual 30 lb. LP bottles
 Dual channel exterior speaker
 Factory installed roof ladder
 Galvalume steel coated outside kitchens
 HELIX Cooling System™ (industry exclusive):
 - Jayco exclusive insulated dual duct design
 - Directional and closeable A/C vents
 - Larger return air vents with user accessible filters
 Independent satellite and cable hookups
 LED exterior lighting package
 LP quick connect for gas griddle (next to JayPort)
 Metal slam latch baggage doors
 Nautilus 2.5 water connections
 Nitrogen filled undermount spare tire (15 in.)
 Quick connect water connections (door side hot/cold and off door side cold only)
 Slide topper/awning prep
 Stronghold VBL™ walls (laminated sidewalls, rear walls and slide out walls)

INTERIOR

2 piece high gloss bathroom surround
 5/8 in. tongue-and-groove plywood flooring
 75 lb. full extension drawer guides
 Bathroom skylight
 Bedroom TV prep

C.P.A.P. prepped bedroom
 Extra 120V power outlets in kitchen and slide rooms (where applicable)
 Gas strutted under bed storage
 Handcrafted and glazed door/drawer fronts (new sizes)
 Inverter pre-wire (multiple locations) ((7) 110 outlets (4 USB's 12V)
 Matte black kitchen faucet with pull-out sprayer
 Porcelain foot flush toilet
 Residential vinyl flooring throughout
 Solid hardwood slide fascia
 Stainless steel kitchen sink
 Theater seating (select models)
 Tri-fold hide-a-bed sofa with residential memory foam sleep surface (select models)
 USB charging ports (multiple locations throughout)

CUSTOMER VALUE PACKAGE (MANDATORY)

15K BTU "Whisper Quiet" A/C and bedroom A/C prep
 4K Ultra LED HD Smart TV in living room (39 in.)
 50-amp service with dual A/C ducts
 60K on-demand water heater with mixing tank
 Custom machined aluminum rims
 Electric patio awning with integrated LED lights
 GE black and stainless 17 in. range with edge to edge grates
 GE microwave
 Hidden hinges on cabinet doors
 Keyed-Alike™ lock system
 Rain proof bathroom power vent
 Rear 2 in. towing receiver (4-pin connector on fifth wheels only)
 Security monitor prep (rear)
 Upgraded friction hinge entrance door

LUXURY PACKAGE (MANDATORY)

Blackout roller shades with reflective side throughout
 Electric auto-leveling
 GE 10 cu.ft. 12V refrigerator
 JayPort 2 in. mount (for outside accessories)
 Residential style glass shower door
 XL grab handle

4-STAR HANDLING PACKAGE (MANDATORY)

Dexter® Axles with NEV-R-Adjust® brakes and E-Z Lube® hubs
 Goodyear® Endurance® tires (load range E)
 MORryde® CRE-3000™ rubberized suspension
 Wet bolt fasteners with bronze bushings

OPTIONS

15K bedroom A/C
 22 in. outside griddle with deep sink attachment for JayPort system
 Booth dinette (select models)
 Free standing table with leaf and bench seat
 LED fireplace with 5,000 BTU electric space heater (select models)
 Overlander 1 Solar Package: (1) 200W panels, MPPT 30-amp solar controller
 Residential 60 in. x 80 in. queen size mattress
 Theater seating in place of tri-fold sofa (select models)

*Indicates split tanks

FLOORPLAN	TOTAL EXTERIOR LENGTH	EXTERIOR WIDTH	EXTERIOR HEIGHT (WITH A/C)	INTERIOR HEIGHT (MAIN)	INTERIOR HEIGHT (UPPER DECK)	UNLOADED VEHICLE WEIGHT	DRY HITCH WEIGHT	GVWR	CARGO CARRYING CAPACITY	FRESH WATER CAPACITY	GRAY WASTE WATER CAPACITY	BLACK WASTE WATER CAPACITY	SLEEPING CAPACITY
25RUC	29' 5"	8' 1"	12' 5"	8' 5"	6' 3"	8,010	1,610	9,500	1,490	52	82*	45	3-5
26REC	29' 5"	8' 1"	13' 0"	8' 5"	6' 3"	8,055	1,615	9,750	1,695	52	82*	45	1-2
29DDB	34' 7"	8' 1"	12' 11"	8' 5"	6' 3"	9,040	1,715	10,175	1,710	52	82*	45	5-7
29RLC	34' 1"	8' 1"	12' 6"	8' 5"	6' 3"	9,205	1,690	10,750	1,545	52	82*	45	3-4

Meet your Jayco Dealer



Scan QR code for specification definitions

Some specs at the time of print may include estimates. For the most updated information, please visit Jayco.com

Jayco, Inc. | P.O. Box 460 | Middlebury, IN 46540

See dealer for further information and prices. All information in this brochure and on www.jayco.com is the latest available at the time of publication approval. Jayco reserves the right to make changes and to discontinue models without notice or obligation. Photography may show optional equipment or props used for decoration purposes only. RVs built for sale in Canada may differ to conform to Canadian codes. JAYCO and the JAYCO BIRD IN FLIGHT are registered trademarks of Jayco, Inc. Printed in USA 10/23 ©2023 Jayco, Inc.



Jayco - Part of Jayco Family of Companies