

Jayco | 2024 Eagle Travel Trailer

# EAGLETT

ADVENTURES AROUND EVERY BEND



# INTERIOR DESIGN



## CLASSIC FARMHOUSE



Main Wood



Accent Wood



Floor



Countertop

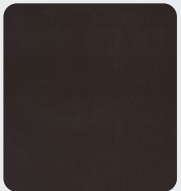

Main Fabric



Accent Fabric

**284BHOK**

OPTIONS: A, C, D

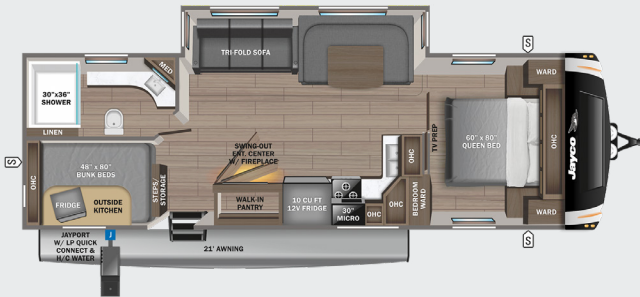

**294CKBS**

OPTIONS: A, B, E

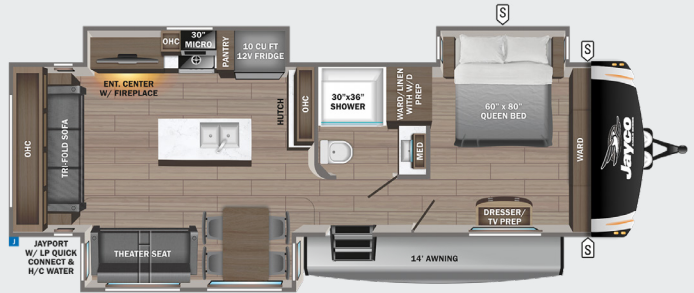

**295RUCD**

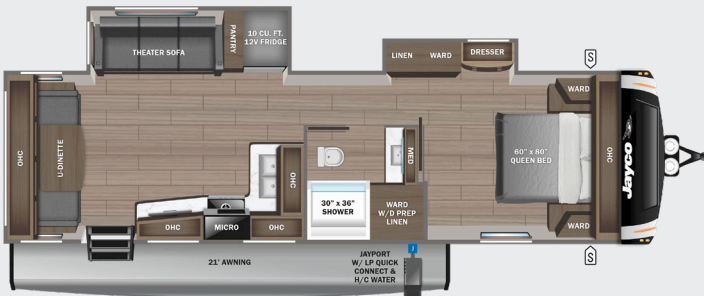

**312BHOK**

OPTIONS: A, C, D

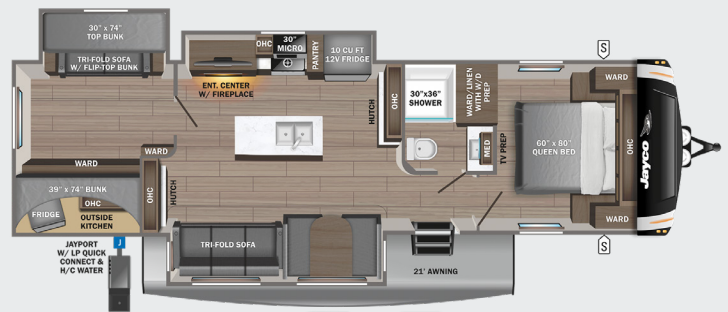

**320FBOK**

OPTIONS: C, D, E



	STORAGE
	MICROWAVE
	OVERHEAD CABINETS
	REFRIGERATOR
	WARDROBE

**OPTIONS**

**A**



Table & Chairs/Bench

**B**



Dinette

**C**



Table & Chairs

**D**



Theater Seat

**E**



King Bed

# STANDARDS & OPTIONS

## EXTERIOR

- 1.5 in fresh water drain valve
- 5 in. Magnum Truss™ Roof System with limited lifetime warranty
- 50-amp detachable power cord
- LED lighting in pass through area with 3-way switches
- Auto-grade vinyl graphics
- Automotive style painted front cap with max turn radius (painted on select models)
- Battery disconnect in pass through area
- Black tank flush
- Climate Shield™ zero-degree tested weather protection:
  - Fully enclosed and heated underbelly (ducted)
  - 35,000 BTU furnace
  - Double layer fiberglass batt insulation in ceiling and floor
  - Double sided radiant barrier insulation (roof, floor and behind cap)
  - PEX plumbing
- Commercial grade rubber flooring in pass through area
- Digital TV antenna with WiFi prep
- Dual 30 lb. propane bottles
- Dual channel exterior speaker
- Factory installed roof ladder
- Galvanized steel coated outside kitchens
- HELIX Cooling System™ (industry exclusive):
  - Jayco exclusive insulated dual duct design
  - Directional and closeable A/C vents
  - Larger return air vents with user accessible filters
- Independent satellite and cable hookups
- JaySMART™ (Safety Marker And Reverse Travel) exterior LED lights
- LED exterior lighting package
- Propane quick connect for gas griddle (next to JayPort)
- Metal slam latch baggage doors
- Nautilus 2.5 water connections
- Nitrogen filled undermount spare tire (model/option varies 15 in. or 16 in.)
- Quick connect water connections (door side hot/cold and off door side cold only)
- Slide topper/awning prep
- Stronghold VBL™ walls (laminated sidewalls, rear walls and slide out walls)

## INTERIOR

- 2 piece high gloss bathroom surround
- 5/8 in. tongue-and-groove plywood flooring
- 75 lb. full extension drawer guides

- 90 in. x 92 in. residential quilted bedspread (both queen and king mattresses)
- Bathroom skylight
- Bedroom TV prep
- C.P.A.P. prepped bedroom
- Extra 120V power outlets in kitchen and slide rooms (where applicable)
- Furniture cup holder tables (1 pair)
- Gas strutted under bed storage
- Handcrafted and glazed door/drawer fronts (new sizes)
- Inverter pre-wire (multiple locations) (7) 110 outlets) (6 USB's 12V)
- LED backlit medicine cabinet with custom framed mirror
- LED lights with dimmer switches and motion activated (throughout interior)
- Matte black kitchen faucet with pull-out sprayer
- Porcelain foot flush toilet
- Residential 60 in. x 80 in. queen size mattress
- Residential vinyl flooring throughout
- Solid hardwood slide fascia
- Stainless steel kitchen sink
- Theater seating (select models)
- Tri-fold hide-a-bed sofa with residential memory foam sleep surface (select models)
- USB charging ports (multiple locations throughout)

## CUSTOMER VALUE PACKAGE (MANDATORY)

- 15K BTU "Whisper Quiet" A/C and bedroom A/C prep
- 43 in. 4K Ultra LED HD Smart TV in living room
- 50-amp service with dual A/C ducts
- 60K on-demand water heater with mixing tank
- Custom machined aluminum rims
- Electric patio awning with integrated dimmable LED lights
- GE 30 in. over-the-range black and stainless microwave with exhaust fan
- GE black and stainless 21 in. range with edge to edge grates
- Hidden hinges on cabinet doors
- JBL Aura Bar 12V with Bluetooth® and dual HDMI (dual zone)
- Keyed-Alike™ lock system
- MORryde Step Above™ entrance steps (main entrance) with blue LED
- Rain proof bathroom power vent
- Rear 2 in. accessory receiver
- Security monitor prep (rear, sides and entrance door)
- Upgraded friction hinge entrance door

## LUXURY PACKAGE (MANDATORY)

- Blackout roller shades with reflective side throughout
- Electric leveling front legs with electric rear stabilizer jacks
- GE 10 cu.ft. 12V refrigerator
- JAYCOMMAND® "Smart RV System" (Pro Tablet)
- JayPort 2 in. mount (for outside accessories)
- LED fireplace with 5,000 BTU electric space heater (select models)
- MORryde Safe-T-Rail grab handle
- Overlander 1 Solar Package (200W panel and 30-amp solar controller)
- Residential style glass shower door
- TPMS (Tire Pressure Monitoring System) in-stem monitoring
- Washer/dryer prep (select models)

## 5 STAR HANDLING PACKAGE (MANDATORY)

- Dexter® ABS brake system with anti-sway
- Dexter® Axles with NEV-R-Adjust® brakes and E-Z Lube® hubs
- Goodyear® Endurance® tires (load range E)
- MORryde® CRE-3000™ rubberized suspension
- Wet bolt fasteners with bronze bushings

## OPTIONS

- 15,000 BTU bedroom A/C
- 22 in. outside griddle with deep sink attachment for JayPort system
- 360 degree security monitor kit with 7 in. view
- Booth dinette (select models)
- Dry Camping Package (generator prep and extra propane capacity)
- Electric auto-leveling
- Extreme Weather Package with 120 heat pads (12V heat tape on fresh water)
- Frameless dual pane windows
- Free standing table with leaf and bench seat, 2 storage chairs and 2 folding chairs
- Free standing table with leaf, 2 storage chairs and 2 folding chairs in place of booth dinette
- LED fireplace with 5,000 BTU electric space heater (select models)
- Overlander 2 Solar Package: (2) 200W panels, MPPT 30-amp solar controller and 1800W inverter)
- Overlander 4 Solar Package: (4) 200W panels, (2) 100AH lithium batteries, 60-amp MPPT solar controller, 3000 W split phase inverter/charger, DC/DC power converter, soft start 15,000 A/C with heat pump, battery monitor, roof pre-wire solar, generator option, battery enclosed)
- Residential 72 in. x 80 in. king size mattress (select models)
- Theater seating in place of tri-fold sofa (select models)

\*Indicates split tanks

FLOORPLAN	TOTAL EXTERIOR LENGTH	EXTERIOR WIDTH	EXTERIOR HEIGHT (WITH A/C)	INTERIOR HEIGHT	UNLOADED VEHICLE WEIGHT	DRY HITCH WEIGHT	GVWR	CARGO CARRYING CAPACITY	FRESH WATER CAPACITY	GRAY WASTE WATER CAPACITY	BLACK WASTE WATER CAPACITY	SLEEPING CAPACITY
284BHOK	34' 10"	8' 1"	11' 8"	7' 0"	7,855	1,055	9,995	2,140	81	74*	37	6-8
294CKBS	38' 0"	8' 1"	11' 10"	7' 0"	9,460	1,210	11,450	1,990	81	74*	37	4-6
295RUCD	33' 8"	8' 1"	TBD	7' 0"	TBD	TBD	TBD	TBD	81	74*	37	TBD
312BHOK	38' 9"	8' 1"	11' 11"	7' 0"	9,870	1,350	11,500	1,630	81	74*	37	8-10
320FBOK	38' 0"	8' 1"	11' 9"	7' 0"	9,085	1,230	11,000	1,915	81	74*	37	4-6

Meet your Jayco Dealer



Scan QR code for specification definitions

Some specs at the time of print may include estimates. For the most updated information, please visit [Jayco.com](http://Jayco.com)

Jayco, Inc. | P.O. Box 460 | Middlebury, IN 46540

See dealer for further information and prices. All information in this brochure and on [www.jayco.com](http://www.jayco.com) is the latest available at the time of publication approval. Jayco reserves the right to make changes and to discontinue models without notice or obligation. Photography may show optional equipment or props used for decoration purposes only. RVs built for sale in Canada may differ to conform to Canadian codes. JAYCO and the JAYCO BIRD IN FLIGHT are registered trademarks of Jayco, Inc. Printed in USA 10/23 ©2023 Jayco, Inc.



Jayco - Part of Jayco Family of Companies